

MARINE SHACKLES

Stainless Steel 316 Twist

Benefits

Contrary to upset forms produced in several press operations, electrical upsetting produces no kinks or interruption of grain flow. The surface of the shackle is free from wrinkles or burrs. The cold shank remains totally undamaged.

Even when the shackle heads are pressed into their final shape, the grain structure of the external contour retains a high degree of accuracy.

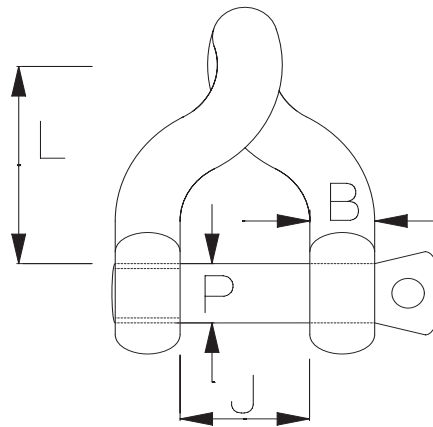

Inspection certificate BS EN10204 3.1b available on request. This must be specified at the time of order.

Shackle Pin Types

Pin	Description	Sizes
	Standard Screw Pin	4mm to 19mm
	Shake Proof Retain Pin	5mm to 16mm
	Socket Head Pin	5mm to 19mm

Suffix Code with pin type.
 No Suffix - Standard Pin
 RS - Shake Proof Pin
 C - Socket Head Pin

Stainless Steel 316 Twist Shackles

Product Code	Pin P	Body B	Jaw J	Inside L	M.B.L. *	Weight
T04	4mm	4mm	8mm	13mm	600 Kgs	7g
T05	5mm	5mm	10mm	16mm	1200 Kgs	13g
T06	6mm	6mm	13mm	20mm	1600 Kgs	24g
T08	8mm	8mm	16mm	26mm	2400 Kgs	53g
T10	9.5mm	9.5mm	19mm	31mm	3800 Kgs	97g
T11	11mm	11mm	22mm	35mm	4800 Kgs	152g
T12	12.7mm	12.7mm	26mm	41mm	6000 Kgs	237g
T16	16mm	14.3mm	29mm	45mm	8000 Kgs	450g
T19	19mm	16mm	32mm	51mm	11000 Kgs	585g

Larger shackles manufactured to order.

* typical minimum breaking load

Refer to shake proof and socket head shackle specification sheet for details of pins. Specialist shackles to OEM design also available. Contact our sales department for a very competitive quote.